

IBM® ThinkPad® T20

Setup Guide

P/N: 46L4324



Checklist for unpacking

Thank you for purchasing the IBM ThinkPad T20 computer. Match the items on this list with the items in the box. If any item is missing or damaged, please contact your place of purchase.

Computer

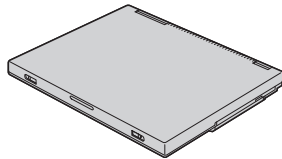

Diskette drive

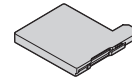

Telephone cable

AC adapter

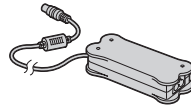

CDs:



- *Software Selections CD*
- *Recovery CD kit for Windows®*

Miscellaneous parts

- Security screw
- TrackPoint® cap

With some models, additional items may be provided.

Power cord

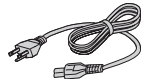

Publications

- *Setup Guide*
- *User's Reference*
- *Manual package for Microsoft® Windows*



Battery pack

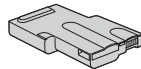

Note: For how to install the battery pack in the computer, refer to the online information. For access to that information, use the ac adapter to turn on the computer.



Setting up your computer

1 Connecting to a power source.

Connect the ac adapter to the computer's power jack (at the rear of the computer). Make the connections in the order shown.

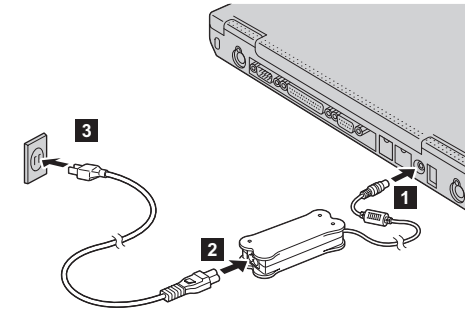

2 Turning on the system.

a) Open the liquid crystal display (LCD).

Press the LCD latches **1** and open the LCD **2**. Then position the LCD so that it is convenient for viewing.

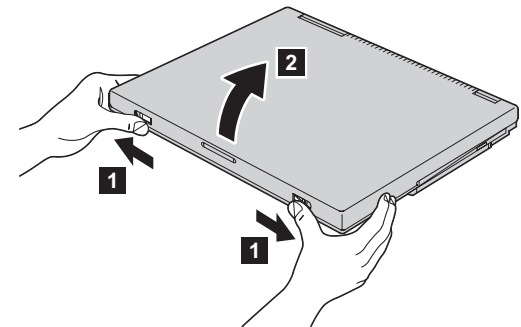

b) To turn on the computer, push the power switch **1**.

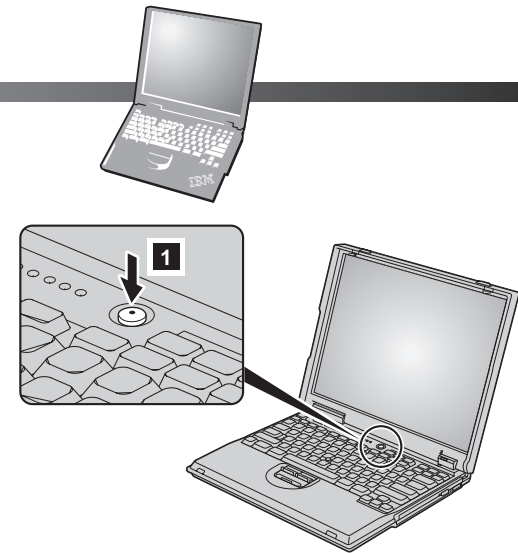

3 Using the TrackPoint pointing device

The TrackPoint pointing device is a unique system for moving the cursor on the screen. Using the TrackPoint stick and buttons, you can perform all mouse operations. The left and right click buttons function like the left and right buttons on a mouse.

To move the cursor, use the red-topped stick in the center of the keyboard. Press gently with your left or right index finger in the direction you want to move the cursor. To select and drag an object, press and hold one of the buttons with either thumb, as required by your software.

Click means to press the left button once. **Double-click** means to press the left button twice within 1 second.

For more information about the TrackPoint pointing device, see the online information. You can launch it by pressing the ThinkPad Button. Refer to page 5 on the ThinkPad Button.

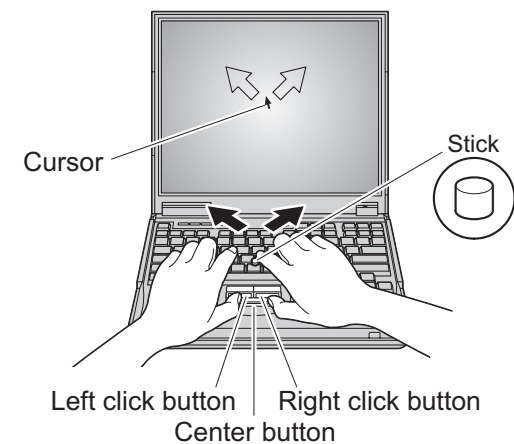



4 Using the volume control.

You can adjust the sound level produced by the built-in speakers by using the following three buttons:

- 1** Volume down
- 2** Volume up
- 3** Mute
 - If the sound is muted when you turn off the computer, it remains muted when you turn the computer on again.
 - To turn on the sound, press the Volume up or Volume down button.

When you press one of these buttons, the volume indicator appears on the screen for a few seconds. For more details on volume control, see the online information. You can launch it by pressing the ThinkPad Button. Refer to page 5 on the ThinkPad Button.

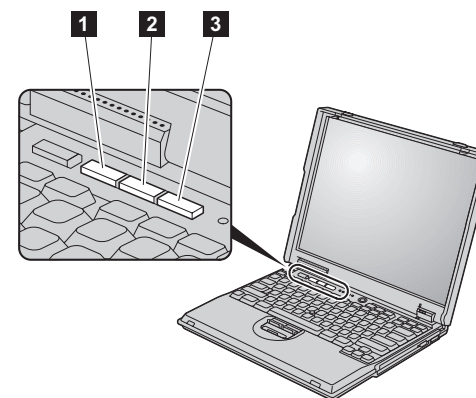

5 Setting up Windows.

The computer is preloaded with Windows 98, Windows 2000, Windows 95, or Windows NT®. To set up the operating system, follow the instructions on the computer display.



6 Using Access ThinkPad

Your computer features the unique ThinkPad Button. Press the ThinkPad Button anytime to open the online help and information center—Access ThinkPad.

With Access ThinkPad, you can obtain information from two sources. On the left, Access ThinkPad offers information from the ThinkPad Assistant, your online user's guide. On the right are Internet portal buttons that link you to helpful Internet Web sites. There is no need to carry heavy manuals or reference books.

With ThinkPad Assistant, you can either perform a Quick Search of the ThinkPad Assistant index or search the entire help system.

If you are logged on to the Internet, click one of the Internet portal buttons in Access ThinkPad to do any of the following:

- Get help and user support
- Update software
- Find business solutions
- Learn about accessories that can help make you even more productive

ThinkPad Button

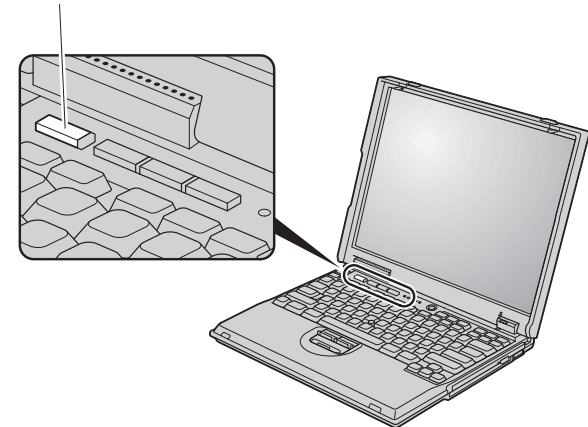

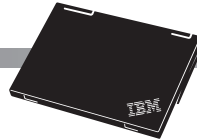

Service and Support information

Getting help around the world

International Warranty Service (IWS) is available for customers who are moving products or traveling to countries where their product (as identified by the 4-digit machine type) is sold and serviced by IBM or IBM-authorized representatives. Warranty service delivery methods of the country providing the service will be in effect. IBM reserves the right to change or modify its service delivery methods by country at any time without notice. Service procedures differ by country, and some service and parts may not be available in all countries because of the laws of that particular country. In some countries, fees may apply to service provided on-site in remote locations.

To register, call one of the following IWS Offices:

Southeast Asia, Australia, New Zealand, and Hong Kong:	61-2-9354-4171
Canada, Latin America, and the U.S.:	1-800-497-7426
	or
	248-740-1215
Europe, Middle East, and Africa:	44-1475-893638
Japan, Korea, China (except Hong Kong), and Taiwan:	81-462-73-7598

The IWS office will issue an International Warranty Service Certificate, which you can use wherever IBM or IBM resellers sell and service this product.

Before you call for service, have on hand:

- The exact wording of any error messages
- Information on the configuration of your hardware and software
- A description of the problem
- Information on any options installed on your system, including serial numbers

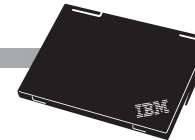

Trademarks

The following terms are trademarks of the IBM Corporation in the United States or other countries or both:

IBM
ThinkPad
TrackPoint

Microsoft, Windows, Windows NT, and the Windows logo are trademarks of Microsoft corporation in the United States and/or other countries.

Your name:

Company name:

Model number:

Serial number:

Company or reseller service:

IBM service Web site:

IBM service number:

Notes:

