

Anchor

Integrated Software For
The Design Professional

Developed to meet the specific needs of practicing Architects and Engineers, Archon software takes a unique approach. And now small and medium sized firms can benefit from state of the art technology that is comprehensive, professional and affordable.

CREATED FOR YOUR FIRM

Integrating a series of sophisticated program modules developed to ease your firm's transition to automated information management, Archon software provides powerful design and accounting tools which can help your firm manage the complexities of today's office environment.

Program modules can be added at any time allowing computer capability to grow with your require-



ments. So now, all your software is available from a single source. Project Management, Accounting and Computer Aided Design form a unified network of application programs that can adapt to your specific needs.

The bottom line for you is a more profitable practice. Best of all, the system gives you more time to be creative.

PROJECT COSTING AND ACCOUNTING

Six modular software programs provide complete in-house project costing, payroll, and accounting services. Unlike many accounting programs, Archon is designed to generate project budget and management data throughout the year, providing precise and up-to-the minute information for accurate decision making.

In addition to the standard report forms, a unique report generator can combine a variety of database information into three dimensional graphs. This three dimensional reporting feature is ideal for Architects interested in getting a quick overview of a project budget or overhead item without sifting through pages of numeric data.

Based on accepted accounting practices of the *AIA Standardized Accounting For Architects*, your firm will find it easy to use and incorporate into your existing accounting procedures.

SUPERIOR COMPUTER AIDED DESIGN SOFTWARE

Archon/2D is a powerful two-dimensional Computer Aided Design and Drafting system that

brings many of the advantages of mainframe CAD to the microcomputer user. Advanced features include automatic dimensioning, user-definable template libraries, multiple drawing levels, and rotatable grids. Archon/2D is interfaced to your Project Costing module to provide accurate records of computer time on selected projects.

Like other Archon software, Archon/2D is easy to use, with help keys and on-screen documentation to provide a rapid learning curve and accelerated system payback.

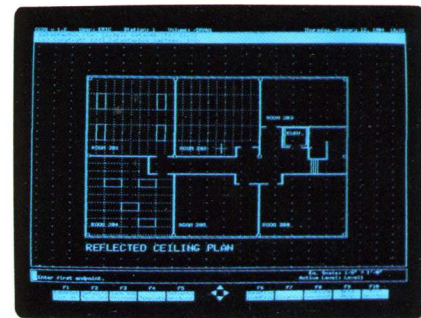

Archon 2D/CAD has advanced features for true production design and drafting.

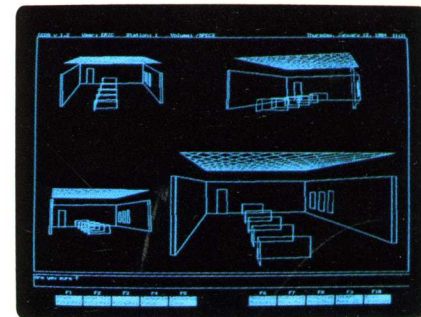

Archon 3D/CAD allows three dimensional wire frame sketches to be viewed from multiple perspectives.

Archon



THREE DIMENSIONAL ARCHITECTURAL MODELING

Archon/3D allows wire frame objects to be interactively created and viewed in three dimensional space. Using a mouse or digitizer, you can create a single sketch that may be seen from any angle. A library function allows standard three dimensional details to be developed and combined to create new structures. As a stand-alone program, or interfaced to Archon/2D, your best design work can now be seen from a new perspective.

OFFICE MANAGER

The Office Manager is designed to maintain, integrate and organize the databases that form Archon. Using new techniques in Context Integrated Software design, Archon software is able to adapt to the structures and relationships that already exist in your own practice. Among the many benefits of this high-level integration is a system which is remarkably easy to use and understand. Multiple level password security protects sensitive information from unauthorized access even on Local Area Networks.

DEPENDABLE SUPPORT

Archon software is developed and supported by DataGraphic Systems, Inc. Registered Architects, professional accountants and qualified technical personnel are available over toll-free customer support numbers. Training aids, a Users Group news letter, and high quality documentation make Archon software easy to install and operate.

AN EXPANDING SYSTEM

Archon software joins other DataGraphic products in an expanding system of professional computerized design, production and management aids. New services and enhancements will continue to be provided to form the most comprehensive solution for the needs of design professionals.

USERS GROUP DISCOUNTS

Firms who have not purchased computer equipment will be interested in our hardware discounts on turn-key packages. Significant savings are possible on selected hardware/software configurations designed to suit your requirements.

FOR MORE INFORMATION

Contact DataGraphic Systems for additional information on equipment requirements, demonstration discs, and pricing information:

Archon Software
DataGraphic Systems, Inc.
218 West Main Street
Charlottesville, Virginia 22901
804/295-2600

Archon Software is a trademark of DataGraphic Systems, Inc.

ARCHON OFFICE MANAGER FEATURES

- Centralized menu options
- Integrated database and program functions
- Supports Local Area Networking
- Multiple level password protection
- On-line help documentation
- Calendar and scheduling enhancements
- Calculator with Foot/Inch conversions
- Help Keys

ARCHON PROJECT COSTING AND ACCOUNTING

- Integrated Project Costing and Accounting Modules
- Single Entry Accounting system
- Multiple report formats
- Spreadsheet input and report forms
- Report Generator
- User-Definable Phases, Services and Departments
- Prints W-2 and 941 forms
- Check register
- Provided with AIA chart of accounts for your modification
- Invoicing, Payroll and Aged Accounts Receivable
- Conforms to *AIA Standardized Accounting For Architects*
- 3-D Bar charts, Pie charts, Line graphs, Ribbon graphs

ARCHON/2D CAD FEATURES

- Fillets, Ellipses, Arcs
- Rotatable and triangular grids
- Architectural or Engineering scaling
- User-defined template libraries
- Shading and Hatching
- Automatic dimensioning

- Multiple drawing levels
- Multiple text fonts
- Text justification
- Distance, area and volume calculations
- Grid snap, lock, origin and multiple grids
- Full zoom and pan
- ASCII text drawing files optional
- Multiple input and output devices
- Windowing and partial delete features
- Database for Bill of Materials
- Automatic time distribution to Project Costing

- On-screen menu selections
- Color capability

ARCHON/3D CAD FEATURES

- Modeling and sketching
- Macro Object definition
- Full three dimensional rotation
- Full zoom capability
- 3D libraries
- Adjustable perspective and object plane
- Interfaces with/2D drawing files
- Stand alone capability
- Color capability

ARCHON Software

218 West Main Street • Charlottesville, Virginia 22901

804/295-2600

